

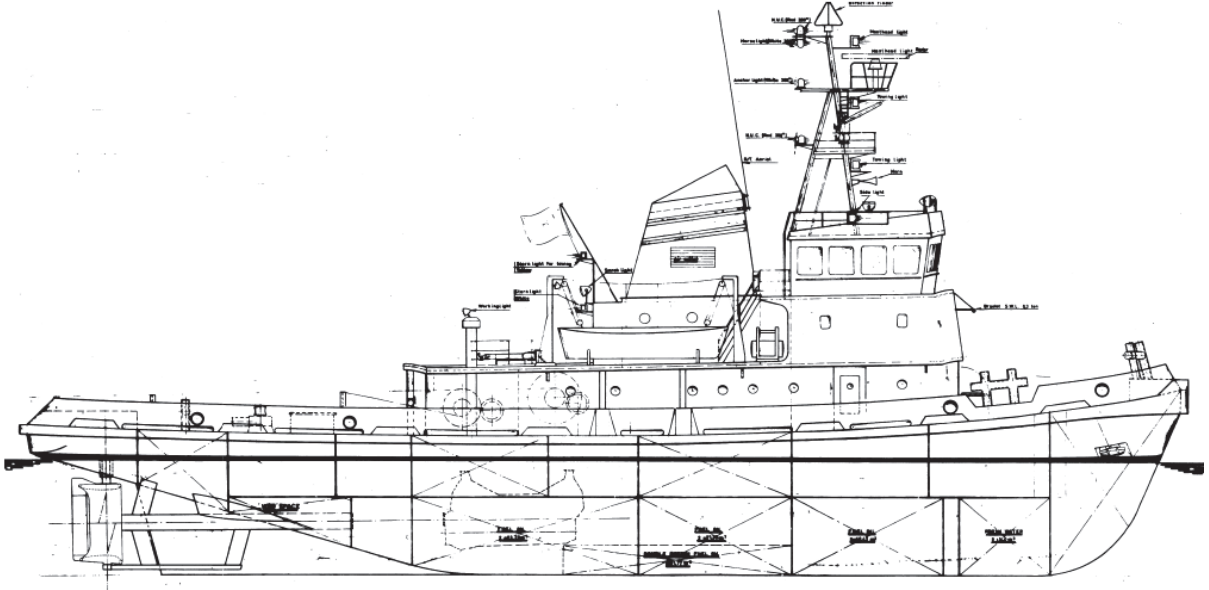

HERCULES

TANKER BERTHING / TOW TUG



PRINCIPAL PARTICULARS

Built	1977
Builder	Dorman Long Vanderbijl, South Africa
Flag	Bahrain
Class	DNVGL
Class No.	08976J
Official No.	BN4035
IMO No.	7510638
Call Sign.	A9D2851
GRT	522
NRT	156
Bollard Pull (T)	53

MACHINERY

Main Engines	Mirrlees Blackstone ESL 15m
Power	4400 hp
Generators	3x 130Kva @ 50Hz
Propellers	2x 2.30m dia variable pitch
Rudders	2x Kort Nozzles

DECK EQUIPMENT

Towing Wire/ Rope	500m x 52mm wire
Towing Winch	Hydraulic remote controlled double drum
Anchor Windlass	4T Hydraulic
Capstan	4T Hydraulic

FIRE FIGHTING EQUIPMENT

1X 400 cbm/hr Fire Pump
2x Fire Monitors with Foam Capacity

PRINCIPAL DIMENSIONS

Length (m)	39.07
Breadth (m)	11.00
Depth (m)	5.21
Max. Draft (m)	4.23

CARGO CAPACITIES

Fuel Oil (m ³)	289
Potable Water (m ³)	49
Ballast Water (m ³)	59
Dispersant (m ³)	19
Foam (m ³)	35

SPEED & CONSUMPTION

Max. Speed (Knots)	13
Daily Consumption (T)	max. 9.5
Economical Speed (Knots)	11
Fuel Type	MGO

NAVIGATION EQUIPMENT

GPS	Gyro Compass
Radar	Gyro Repeater
Echo Sounder	Rudder Indicator
VHF Radio	
VHF Portable	
SSB Radio	
AIS	
Navtex	
GMDSS Radio	
Radar	
Magnetic Compass	



GENERAL ARRANGEMENT PLAN - HERCULES

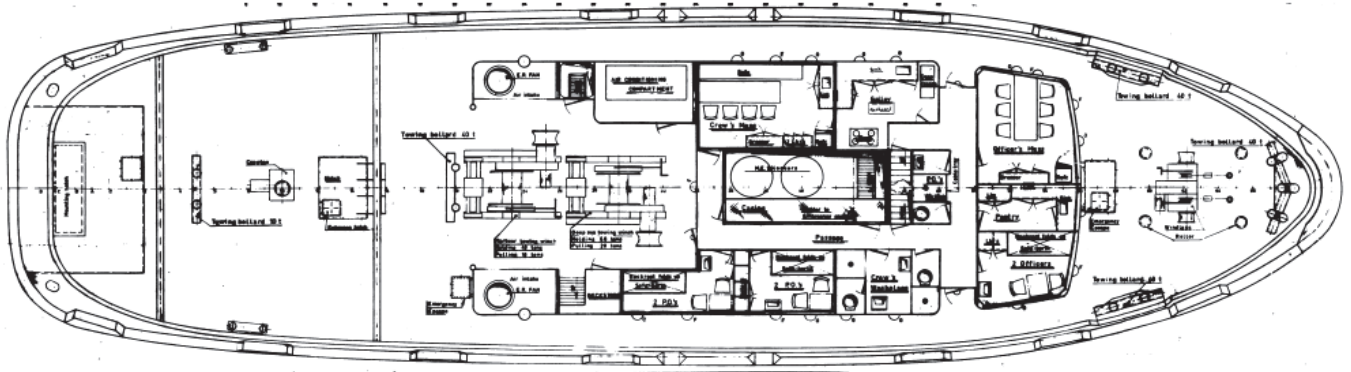

TOP VIEW DECK LEVEL