

GTO 190

BARGE: SPUD

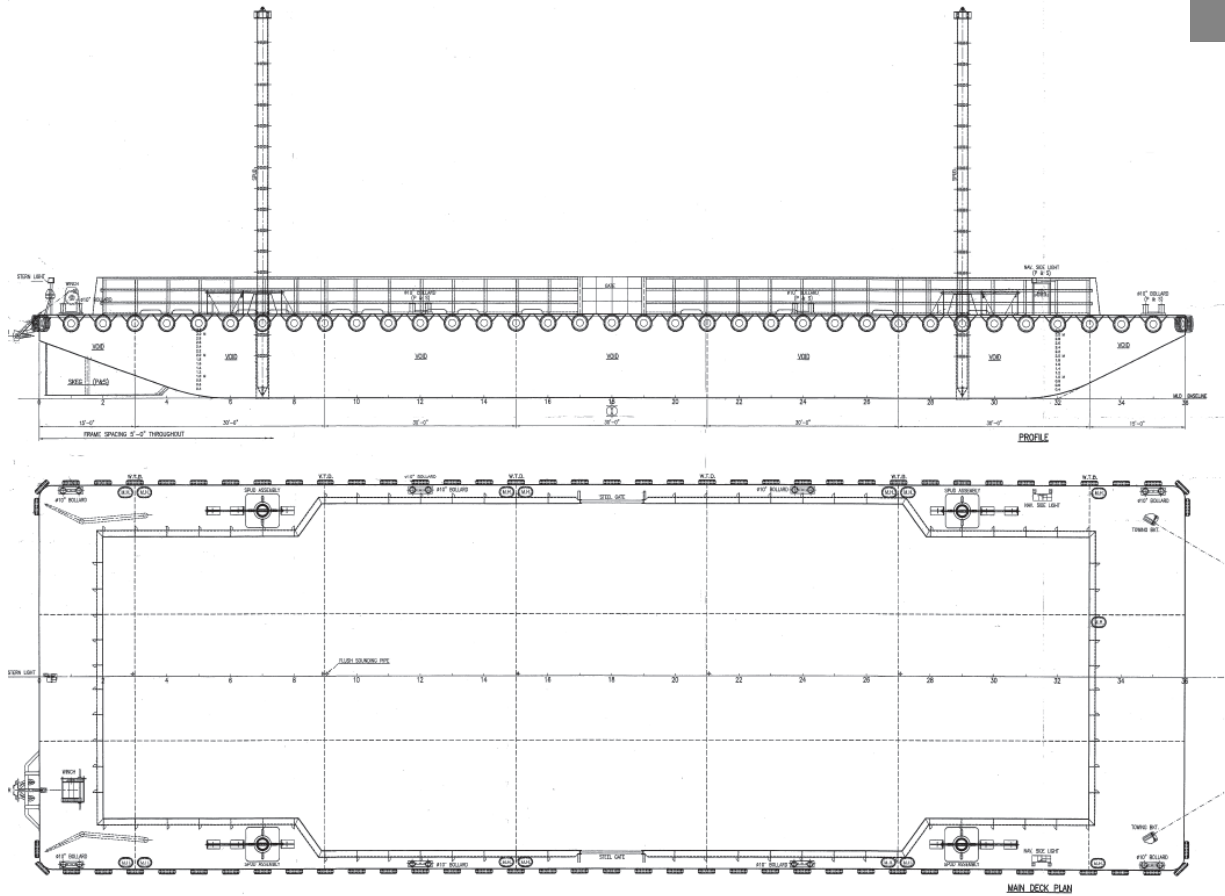

PRINCIPAL PARTICULARS

Built	2008
Builder	Nass Marine Services
Flag	Bahrain
Official No.	BN5075
Class	ABS
Class No.	YY209962
GRT	979
NRT	293
Lightship (T)	457
Deadweight (T)	2424
Displacement (T)	2881

PRINCIPAL DIMENSIONS

Length (m) LOA/LBP	54.86 / 52.67
Breadth (m)	18.29
Depth (m)	3.96
Max. Draft	3.22

CARGO CAPACITIES

Deck Area Approx. m ²	900
Deck Strength T/m ²	15

ALL BARGES CAN BE FITTED WITH SPUD LEGS, SIDE WALLS, RAMP & MOORINGS BY REQUEST.