



DONA X

TOWING TUG



PRINCIPAL PARTICULARS

Built	1975
Builder	Asia Pacific Shipyard, Singapore
Flag	Bahrain
Class	ABS
Class No.	7503396
Official No.	BH8147
Call Sign	A9D2781
GRT	93
NRT	22
Bollard Pull (T)	11
Accommodation	up to 9 berths

MACHINERY

Main Engines	2x Caterpillar D343
Power	730 hp @ 1500 rpm
Generators	1x GM-50Kva, 380/220V, 50Hz, 3Ph 1x GM-40Kva, 380/220, 50Hz, 3Ph
Propellers	2x Fixed Pitch in Kart Nozzles
Rudders	Twin Coupled Flat Blade

DECK EQUIPMENT

Tow Hook	1x 11T with quick release
Anchors	2
Anchor Windlass	Electric

PRINCIPAL DIMENSIONS

Length (m) LBP	21.33
Breadth (m)	6.28
Depth (m)	3.35
Max. Draft (m)	3.05

CARGO CAPACITIES

Fuel Oil (T)	52
Potable Water (T)	12
Ballast Water (T)	10

SPEED & CONSUMPTION

Max. Speed (Knots)	11
Daily Consumption (T)	2.0
Economical Speed (Knots)	10
Fuel Type	Marine Gas Oil

NAVIGATION EQUIPMENT

GPS	1x Koden 1x Samyung
Radar	2x Koden
Echo Sounder	1x Koden
VHF Radio	2x Sailor
SSB Radio	1x JMC
Magnetic Compass	1x MR2



GENERAL ARRANGEMENT PLAN - DONA X

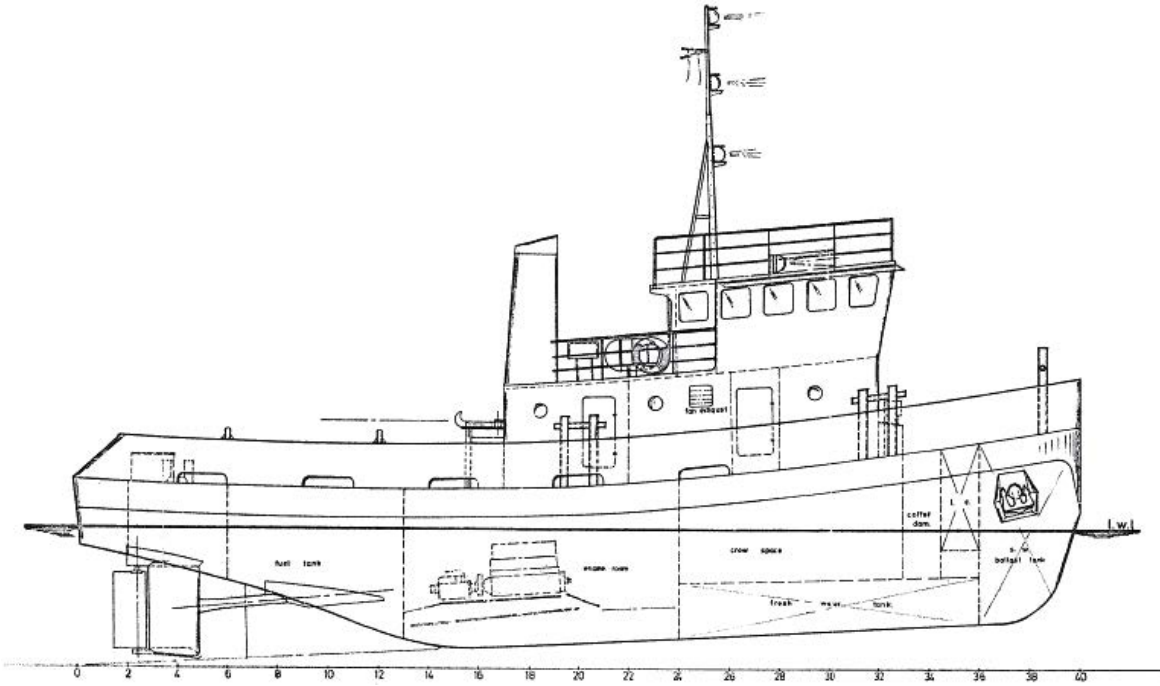

SIDE VIEW

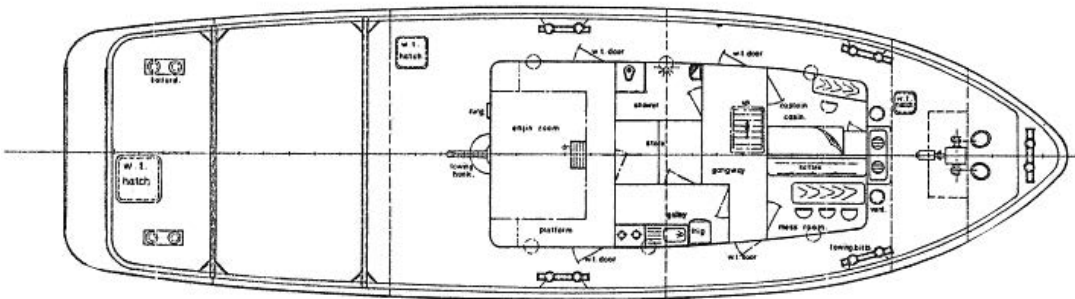

MAIN DECK VIEW

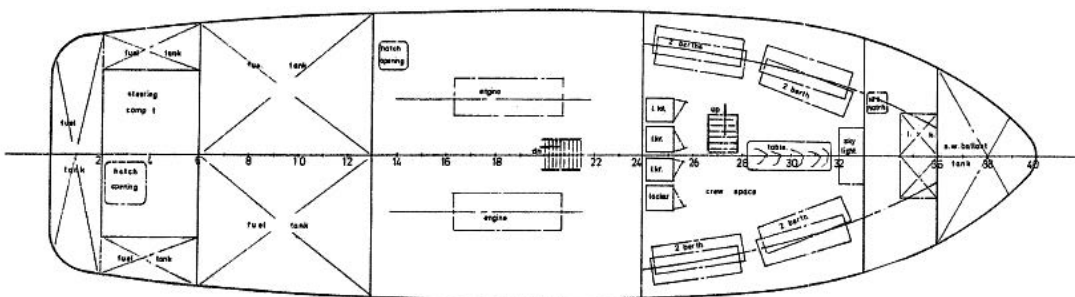

BELOW MAIN DECK VIEW