



PRINCIPAL PARTICULARS

Built	1977 / 1999
Builder	Sing Koon Seng, Singapore
Flag	Bahrain
Class	ABS
Class No.	7707154
Official No.	BN5085
IMO No.	7723558
Call Sign	A9D2014
GRT	146
NRT	49
Deadweight (T)	120
Bollard Pull (T)	15.4

MACHINERY

Main Engines	2x Caterpillar D353
Power	850 hp @ 1225 rpm
Generators	2x GM 80Kva, 415V, 50Hz, 3Ph
Propellers	2x Solid Bronze in Kort Nozzles
Rudders	Twin Coupled Flat Blade

DECK EQUIPMENT

Tow Hook	1x 15T With Release
Towing Wire / Rope	1x 300m / 38mm
Anchor/Towing Winch	1x Single Drum - 40T
Anchors	2x 450Kg With 220m / 19mm
Anchor Windlass	1x 4T @ 10m/min
A Frame	1x 24T

PRINCIPAL DIMENSIONS

Length (m) LOA/LBP	24.38/23.40
Breadth (m)	7.40
Depth (m)	3.90
Max. Draft (m)	3.10

CARGO CAPACITIES

Fuel Oil (m ³)	107
Potable Water (m ³)	25
Ballast Water (m ³)	16

SPEED & CONSUMPTION

Max. Speed (Knots)	9
Daily Consumption (T/day)	3.0
Economical Speed (Knots)	7
Fuel Type	Marine Gas Oil

NAVIGATION EQUIPMENT

GPS	1x Koden
Auto Pilot	1x Wagner
Radar	2x JRC
Echo Sounder	1x Koden
VHF Radio	3x Sailor
SSB Radio	1x JRC
Navtex	1x Lo-Kata
Gyro Compass	1x Tokimec
Magnetic Compass	1x Sauka Keiki
Rudder Indicator	2



GENERAL ARRANGEMENT PLAN - MR. ALI

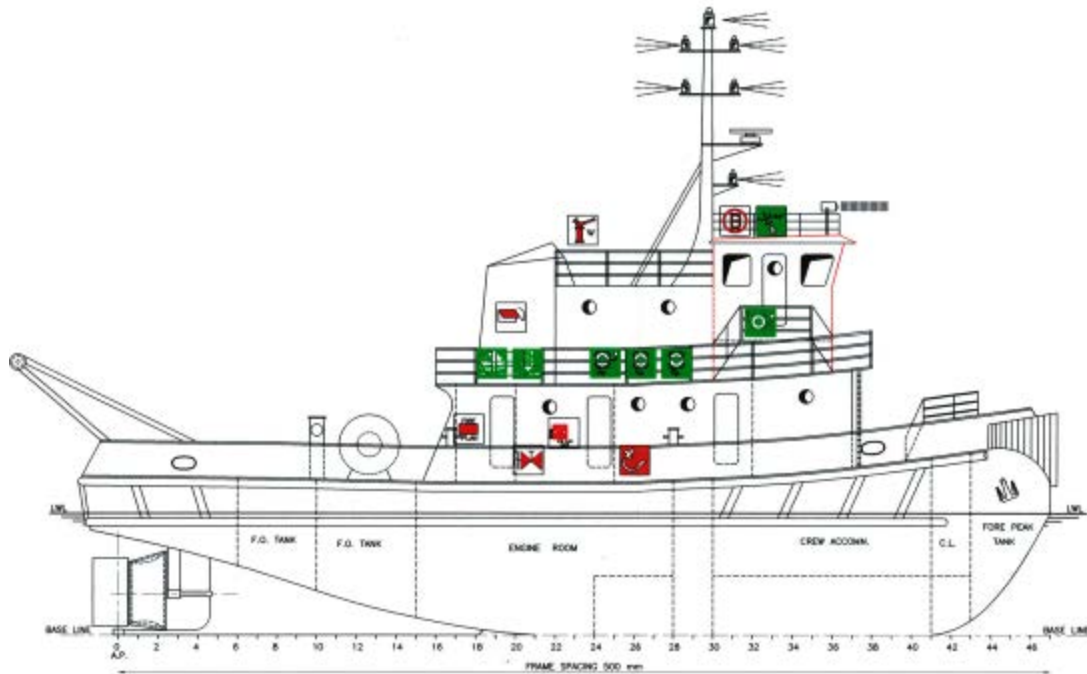

SIDE VIEW

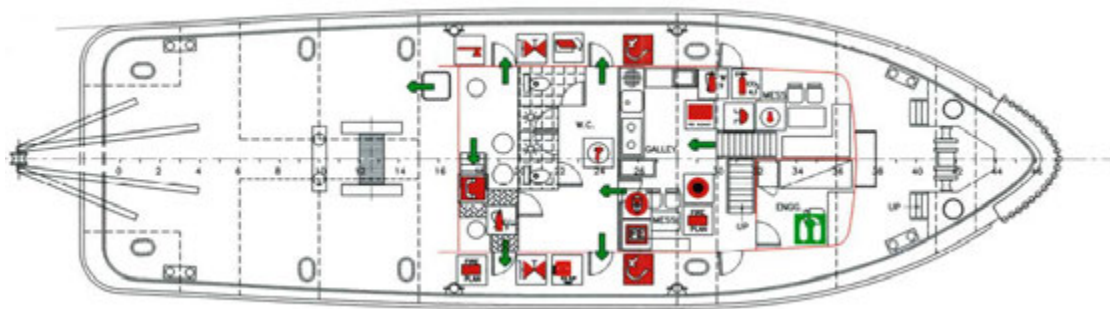

MAIN DECK VIEW

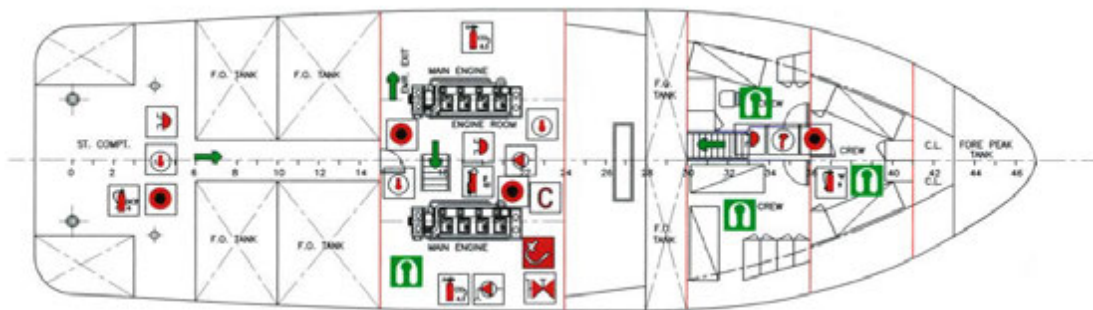

BELOW MAIN DECK VIEW