



# SEA PILOT 3

## PILOT / CREW BOAT



### PRINCIPAL PARTICULARS

Built	1996
Place of build	Holland
Flag	Bahrain
Class	
Class No.	
Official No.	BH 14071
Call Sign	
GRT	103
NRT	31
Crew	4
Passengers	25

### Barhain Coast Guard Approval:

Crew	
Passengers	

### MACHINERY

Main Engines	2x Caterpillar 3512B DI-TA
Total Power	2156 bkW (2932 bhp) @ 1800 rpm
Gearboxes	2 x Reintjes WVS 730/2.269:1
Propellers	2 x Bronze fixedpitch propellers
Diameter	3 blades 1100 mm diameter

### NAUTICAL AND COMMUNICATION EQUIPMENT

Searchlight	2 x Pesch 1000 Watt
Radar system	Icom Mr-61 24nm
Compass	Plath Beta 4
Echosounder	Stowe Navsounder
VHF	Icom IC-M58UK
SSB	Icom IC-M600
GPS	Shipmate RS 5700

### PRINCIPAL DIMENSIONS

Length (m) LOA	26.9
Breadth (m)	6.20
Depth (m)	3.50
Draft Aft. (m)	2.30

### CARGO CAPACITIES

Fuel Oil (m <sup>3</sup> )	14.0
Fresh Water (m <sup>3</sup> )	2.0
Deck Cargo Max (T)	20

### SPEED

Max. Speed (Knots)	22
--------------------	----

### LIFE SAVING EQUIPMENT

Life rafts	2 x 16 persons
Life buoys	2 with smoke & light, 2 with line
Life jackets	30
Fire Extinguishers	2 x 21/2 kg CO <sub>2</sub> , in engine room

### DECK LAY OUT

Anchors	1 x 105kg + 1x60kg H.H.P. Pool N.
Chain (tot.)	10 m chain 12.5 mm + 86 mm P.P line 19 mm

### AUXILIARY EQUIPMENT

Generator sets	2 x Caterpillar 3304B/SR4
Capacity	81 kVA each, 60 Hz, 240/415 V
Networks	24 V d.c., 240 V a.c., 415 V a.c



### GENERAL ARRANGEMENT PLAN - SEA PILOT 3

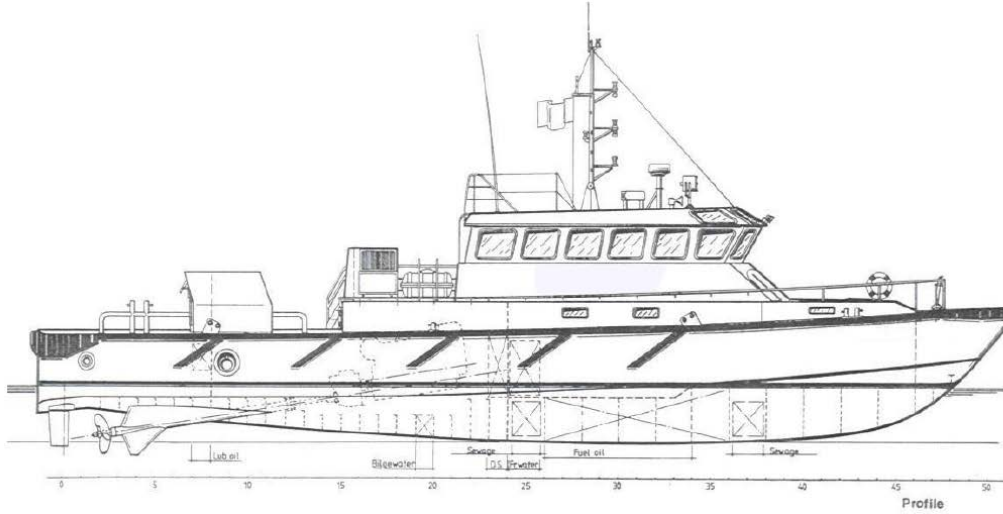

**SIDE VIEW**

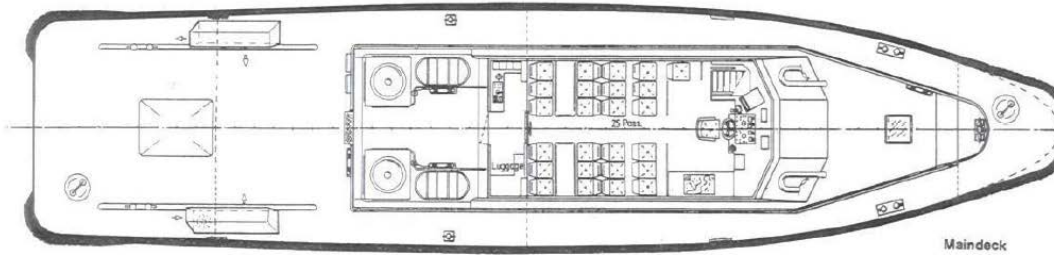

**MAIN DECK VIEW**

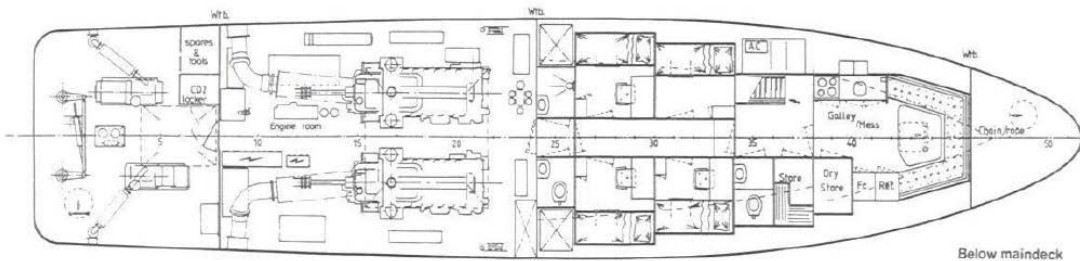

**BELOW MAIN DECK VIEW**