



SEA PILOT 5

PILOT / CREW BOAT



PRINCIPAL PARTICULARS

Built	1996
Place of build	Holland
Flag	Bahrain
Class	ABS
Class No.	9634031
Official No.	BH 14830
Call Sign	A9D3649
IMO	9136175
GRT	103
NRT	31
Crew	4
Passengers	25

Barhain Coast Guard Approval:
Crew
Passengers

MACHINERY

Main Engines	2x Caterpillar 3512B DI-TA
Total Power	2156 bkW (2932 bhp) @ 1800 rpm
Gearboxes	2 x Reintjes WVS 730/2.269:1
Propellers	2 x Bronze fixedpitch propellers
Diameter	3 blades 1100 mm diameter

NAUTICAL AND COMMUNICATION EQUIPMENT

Searchlight	2 x Pesch 1000 Watt
Radar system	Icom Mr-61 24nm
Compass	Plath Beta 4
Echosounder	Stowe Navsounder
VHF	Icom IC-M58UK
SSB	Icom IC-M600
GPS	Shipmate RS 5700

PRINCIPAL DIMENSIONS

Length (m) LOA	26.9
Breadth (m)	6.20
Depth (m)	3.50
Draft Aft. (m)	2.30

CARGO CAPACITIES

Fuel Oil (m ³)	14.0
Fresh Water (m ³)	2.0
Deck Cargo Max (T)	20

SPEED

Max. Speed (Knots)	22
--------------------	----

LIFE SAVING EQUIPMENT

Life rafts	2 x 16 persons
Life buoys	2 with smoke & light, 2 with line
Life jackets	30
Fire Extinguishers	2 x 21/2 kg CO ₂ , in engine room

DECK LAY OUT

Anchors	1 x 105kg + 1x60kg H.H.P. Pool N.
Chain (tot.)	10 m chain 12.5 mm + 86 mm P.P line 19 mm

AUXILIARY EQUIPMENT

Generator sets	2 x Caterpillar 3304B/SR4
Capacity	81 kVA each, 60 Hz, 240/415 V
Networks	24 V d.c., 240 V a.c, 415 V a.c



GENERAL ARRANGEMENT PLAN - SEA PILOT 5

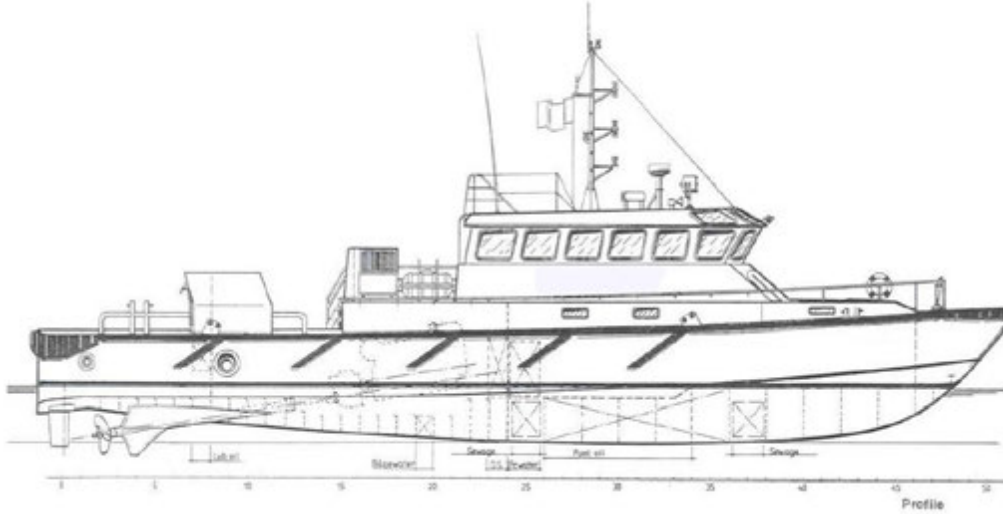

SIDE VIEW

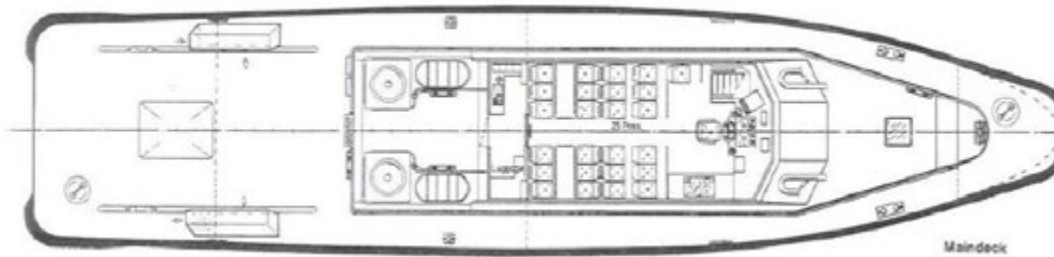

MAIN DECK VIEW

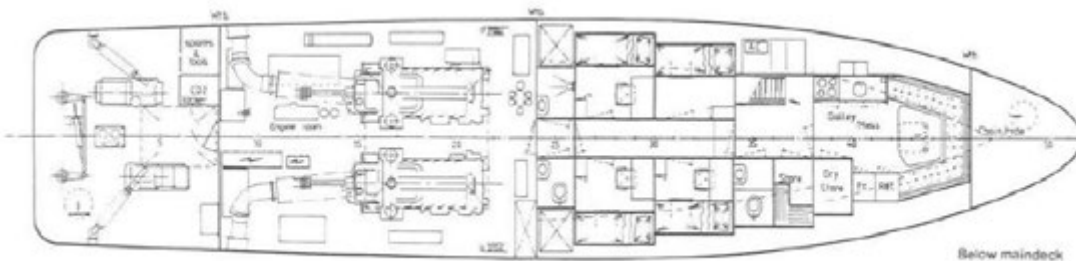

BELOW MAIN DECK VIEW