



# SEA SPRAY

## CREW / PASSENGER BOAT



### PRINCIPAL PARTICULARS

Built	1975 / 2020
Builder	Halter Marine
Flag	Services Bahrain
Official No.	BN8940
Call Sign	A9D2840
GRT	60
Crew	4
Passengers	28

### Barhain Cost Guard Approval:

Crew	4
Passengers	25

### MACHINERY

Main Engines	2x GM
Power	1020 hp
Generators	2x 16KW 20 KW, 220/110V 60Hz
Propellers	2
Rudders	2

### NAVIGATION EQUIPMENT

Radar	
VHF Radio	1x Furuno
Magnetic Compass	1x Seibel

### PRINCIPAL DIMENSIONS

Length (m) LOA	23.08
Breadth (m)	5.52
Depth (m)	2.85
Max. Draft (m)	2.00

### CARGO CAPACITIES

Fuel Oil (USG) Deck	1600
Cargo (T)	5
Deck Area (m <sup>2</sup> )	67
Deck Strength (T/m <sup>2</sup> )	0.5

### SPEED & CONSUMPTION

Max. Speed (Knots)	12
Daily Consumption (T)	1.75
Economical Speed (Knots)	10
Fuel Type	Marine Gas Oil



### GENERAL ARRANGEMENT PLAN - SEA SPRAY

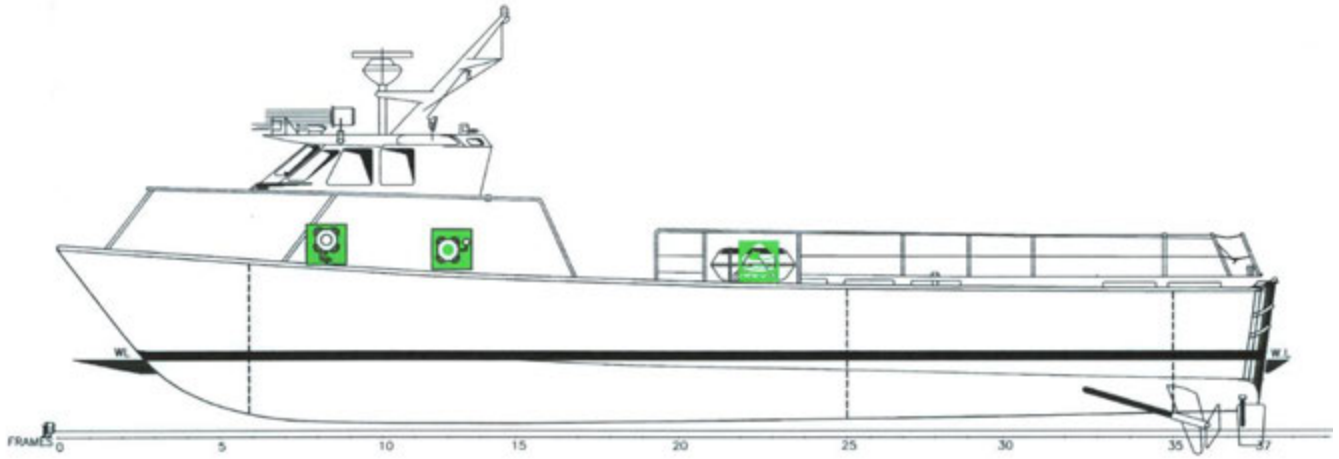

**SIDE VIEW**

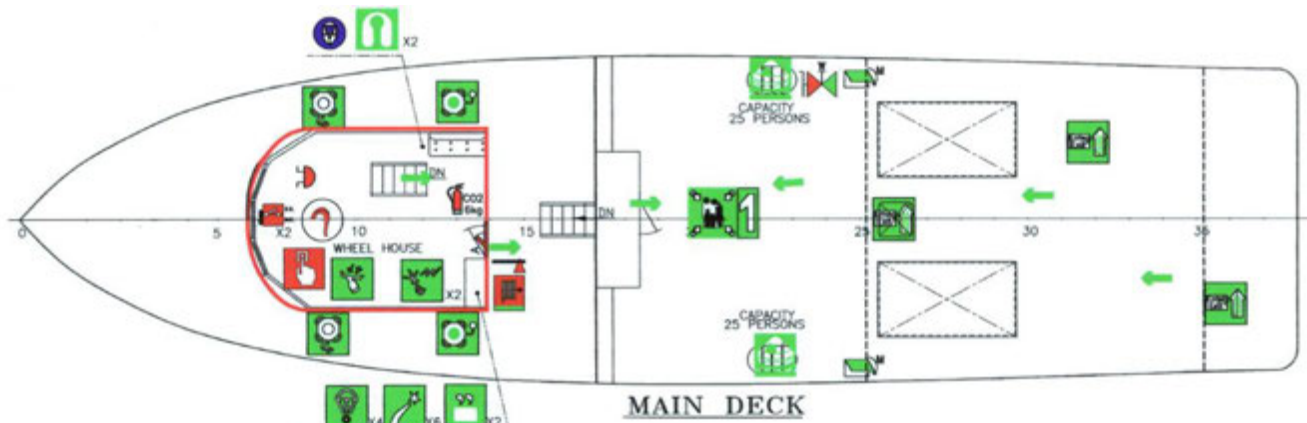

**MAIN DECK VIEW**

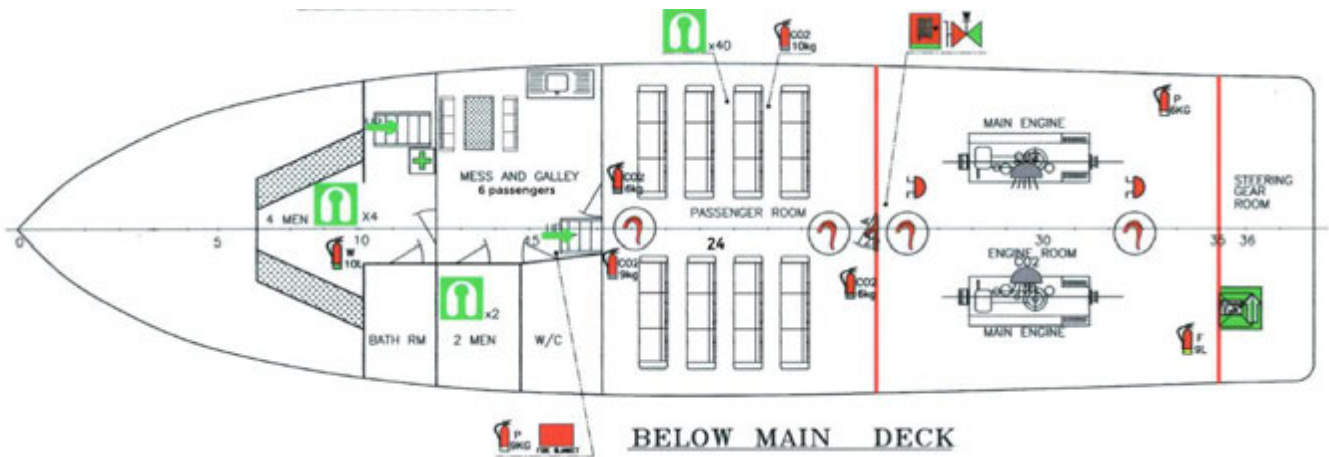

**BELOW MAIN DECK VIEW**