



PRINCIPAL PARTICULARS

Built	1975
Builder	Asia Pacific Shipyard, Singapore
Flag	Bahrain
Class	ABS
Class No.	7503930
Official No.	BH4279
Call Sign	A9D2427
GRT	60
NRT	7
Bollard Pull (T)	5

MACHINERY

Main Engines	2x 300Hp (GM V8-71)
Power	600Hp
Generators	2x GM 37.5Kva, 380V, 50Hz, 3Ph
Propellers	2 Solid in Kort Nozzles
Rudders	Twin Coupled Flat Blade

DECK EQUIPMENT

Towing Wire/Rope	15t with release system
Anchors	2x 800Kg with 22mm/220m
Anchor Winch	2.4 @ 12m/min

PRINCIPAL DIMENSIONS

Length (m) LOA/LWL	17.20 / 16.50
Breadth (m)	5.70
Depth (m)	2.65
Max. Draft (m)	2.20

CARGO CAPACITIES

Fuel Oil (m ³)	27
Potable Water (m ³)	6
Ballast Water (m ³)	7
Deck Strength (T/m ²)	2

SPEED & CONSUMPTION

Max. Speed (Knots)	10
Daily Consumption (T)	2
Economical Speed (Knots)	8
Fuel Type	MGO

NAVIGATION EQUIPMENT

Radar	1x Koden
Echo Sounder	1x Koden
VHF Radio	1x Sailor
Magnetic Compass	Yes
Rudder Indicator	Yes



GENERAL ARRANGEMENT PLAN - AL JABOOR

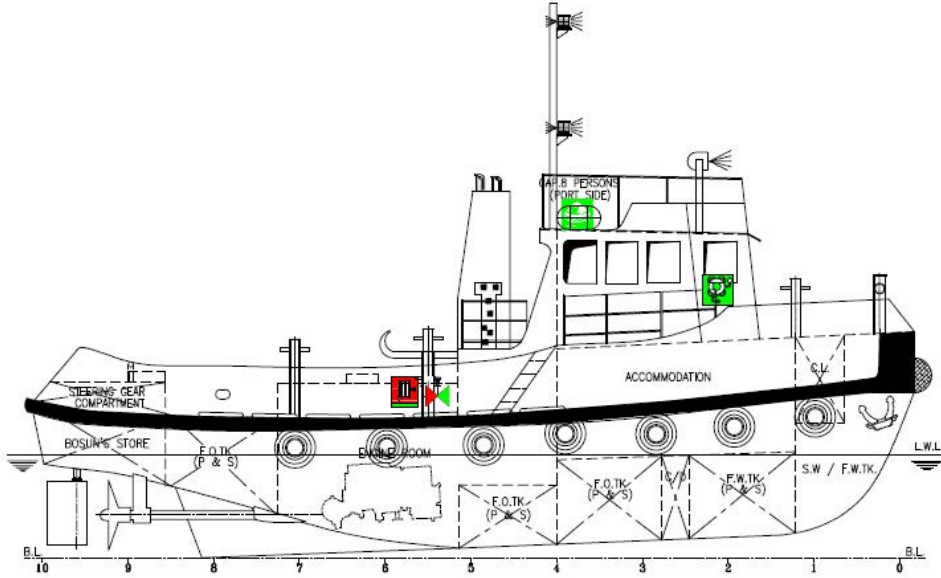

SIDE VIEW

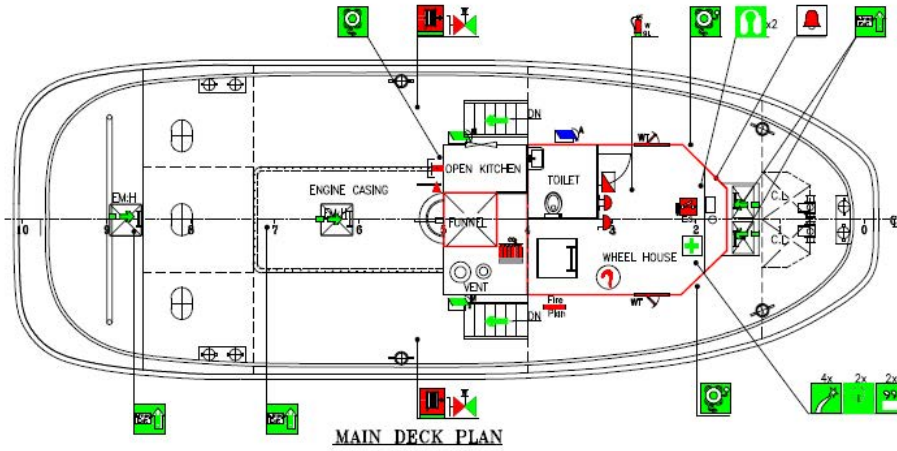

MAIN DECK PLAN

MAIN DECK VIEW

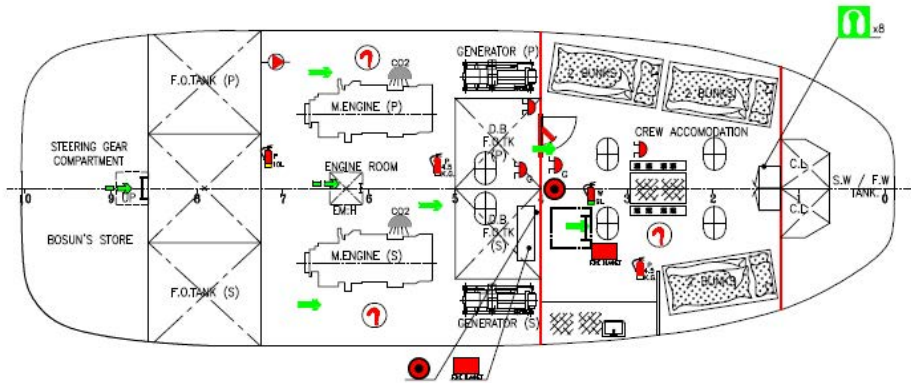

BELOW MAIN DECK VIEW